

C:\QA\Information\681\Workspaces\Bha\fy\PDF\_Color\_600dpi\_with\_level\_export\_131221.plt.ctb  
 D:\code\BPR\15D\_B11\_R052990\_14\_02\_2023\_KES426  
 \Vescod\svl\code\UP\_VP\_Plan\_MTR\_VTL\_BRP\_MTR\_AP\_19.dgn

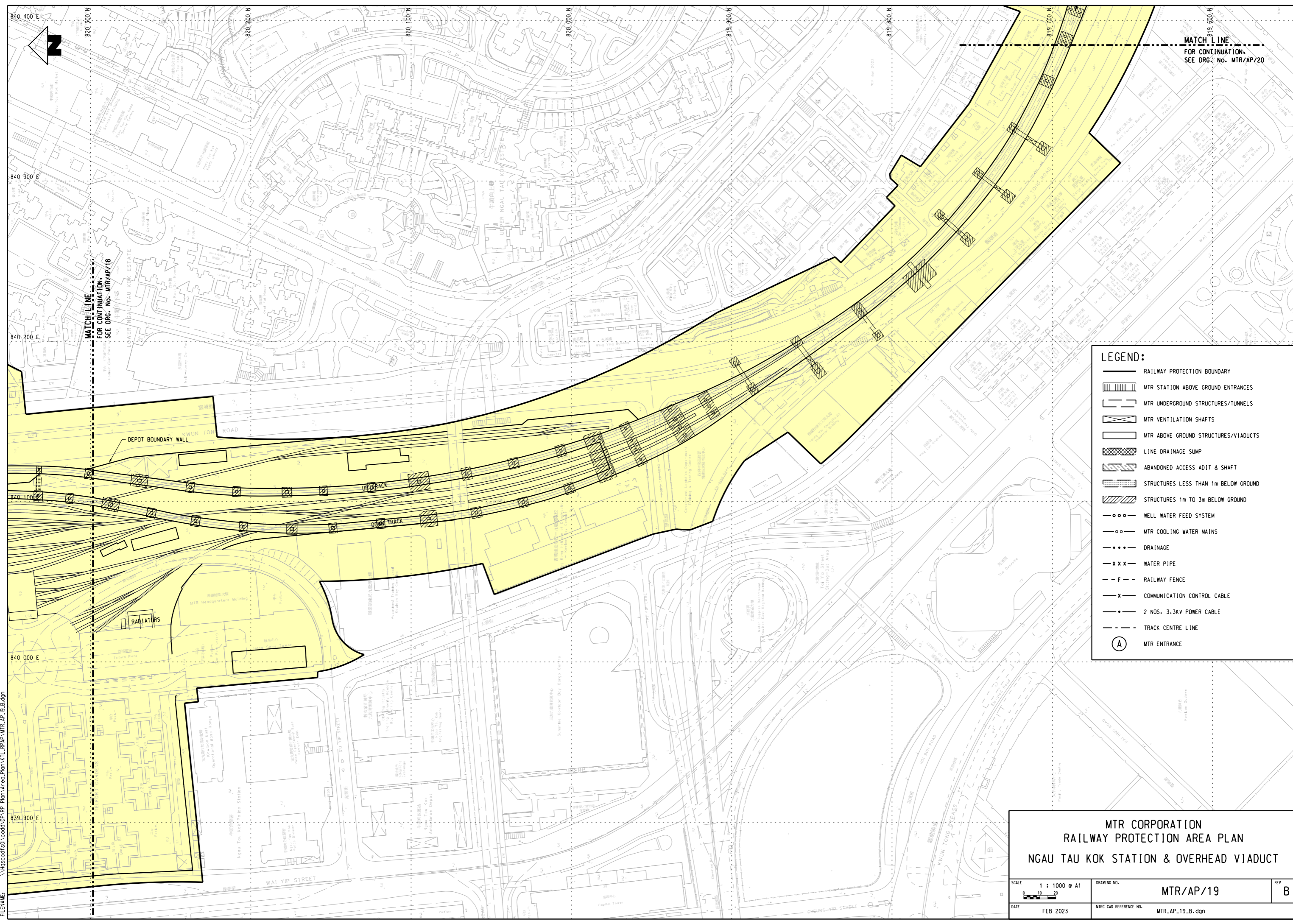

**LEGEND:**

- RAILWAY PROTECTION BOUNDARY
- MTR STATION ABOVE GROUND ENTRANCES
- MTR UNDERGROUND STRUCTURES/TUNNELS
- MTR VENTILATION SHAFTS
- MTR ABOVE GROUND STRUCTURES/VIADUCTS
- LINE DRAINAGE SUMP
- ABANDONED ACCESS ADIT & SHAFT
- STRUCTURES LESS THAN 1m BELOW GROUND
- STRUCTURES 1m TO 3m BELOW GROUND
- WELL WATER FEED SYSTEM
- MTR COOLING WATER MAINS
- DRAINAGE
- WATER PIPE
- RAILWAY FENCE
- COMMUNICATION CONTROL CABLE
- 2 NOS. 3.3KV POWER CABLE
- TRACK CENTRE LINE
- MTR ENTRANCE

**MTR CORPORATION**  
**RAILWAY PROTECTION AREA PLAN**  
**NGAU TAU KOK STATION & OVERHEAD VIADUCT**

|                        |   |                 |
|------------------------|---|-----------------|
| SCALE<br>1 : 1000 @ A1 | DRAWING NO.<br><b>MTR/AP/19</b>           | REV<br><b>B</b> |
| DATE<br>FEB 2023       | MTRC CAD REFERENCE NO.<br>MTR_AP_19_B.dgn |                 |

MATCH LINE  
 FOR CONTINUATION.  
 SEE DRG. No. MTR/AP/20

MATCH LINE  
 FOR CONTINUATION.  
 SEE DRG. No. MTR/AP/18